

## KEY FEATURES

- Elevate™ 150 x 60mm Wide Pocket FrontGLAZE™ shopfront framing system designed to accept thick glass with 20.50mm wide by 32mm deep glazing pocket.
- Internal or external glazing, fixed, doors or awning sashes.
- Heavy duty tubular interlocking mullion option suitable for tall frames (4000mm max.) without transoms.
- Matching heavy duty 50mm thick door that will also accept thick glass using snap on glazing beads.
- We have custom frame sections to accept hook hinge awning sashes.
- Braced fixed framing bead designed to stay in place under high negative wind loads.
- High water resistance can be achieved using the appropriate mullion combinations. Water resistance 600Pa internally or externally glazed.
- Two fully beaded door midrail sizes to choose from (125 and 200mm deep).

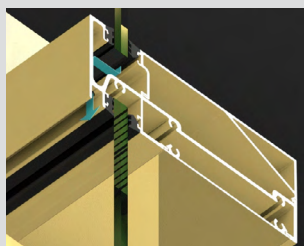

Concealed drainage in transom allows water to escape via face of the system.

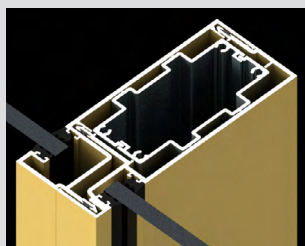

Heavy duty tubular interlocking mullion option suitable for tall frames (4000mm max.) without transoms

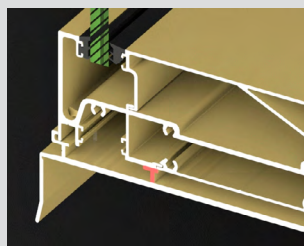

Sub-sills have central support leg, designed to support the weight of heavy glass panels and prevent sill dishing.

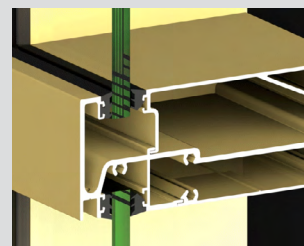

Glazing pocket designed to accept co-extruded captive glazing wedges,

## GENERAL

**Max Panel Height**  
4000mm

**Max Panel Width**  
Various

**Max Glass Thickness**  
16mm

**Frame Depth**  
150mm

## ENERGY

**UW Range**  
4.5 - 6.3

**SHGC Range**  
0.31 - 0.74

## WEATHER

**Maximum Water**  
600Pa.

## ACOUSTICS

**6.5mm VLam Hush™**  
Rw 34 (0;-3)

**10.50mm VLam Hush™**  
Rw 37 (0;-3)

**10.38mm Lam**  
Rw 34 (-1;-2)

**6.38mm Lam**  
Rw 32 (-2;-3)

Based on tests carried out on Series 400 - similar system.